

ABRAZADERA TIPO GOTA

REF: KPL - 750 Z

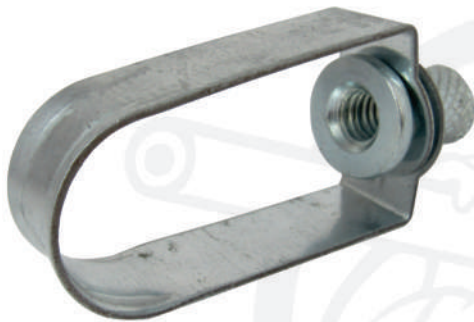

DESCRIPCIÓN:

Las abrazaderas tipo gota, son para suspender tuberías estacionarias. Los bordes acampanados ayudan a evitar que objetos cortantes dañen la tubería.

PRODUCTOS CERTIFICADOS POR UL

Producto fabricado bajo Normas internacionales, dando cumplimiento en laboratorio a rigurosos ensayos que permiten entregar un producto de alta calidad.

Marca: KPL

Material: ACERO

UL: E365032

ABRAZADERA TIPO GOTA ACERO- UL



CÓDIGO
(Sistema)

CÓDIGO
(Fabricante)

MEDIDA

11468

KPL - 750Z

1/2"

11469

KPL - 751Z

3/4"

11470

KPL - 752Z

1"

11471

KPL - 753Z

1-1/4"

11472

KPL - 754Z

1-1/2"

11473

KPL - 755Z

2"

11474

KPL - 756Z

2-1/2"

11475

KPL - 757Z

3"

11476

KPL - 759Z

4"

PRINCIPALES APLICACIONES:

Las abrazaderas tipo gota son aplicadas para asegurar el cableado en conexiones eléctricas y suspender los tubos de forma vertical, horizontal así como rociadores contra incendios, u otros, son fácil y sencillo de utilizar.

- Subestaciones Electricas.
- viviendas.
- Centros Comerciales.
- Hospitales.
- Hoteles, oficinas.
- Minería.

CARACTERÍSTICAS CONSTRUCTIVAS



- posee tuerca de inserción retenida que ayudan a garantizar que la percha del bucle permanezcan juntas (véase figura1-2 ítem-1).
- Con tuerca de inserción moleteada que ayuda a simplificar los ajustes verticales(véase figura 2-ítem2).
- Con bordes acampanados que evitan que superficies afiladas entren en contacto con las tuberías (véase figura 2-ítem3).
- Fabricado según normas UL E365032.



FIGURA 1



FIGURA 2

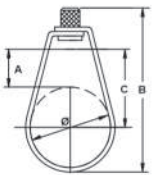

- 1 TUERCA DE INSERCIÓN
- 2 TUERCA MOLETEADA
- 3 FABRICADO DE ACERO

KPL by PST DATOS TECNICOS

ITEM N°	DESCRIPTION	DIMENSIONS			FUERZA ESTATICA	
	STELL CONDUIT	A (MM)	B (MM)	C (MM)	KGF	LBF
	MEDIDA					
1	1/2"	29	40	81	136	300
2	3/4"	23	37	81	136	300
3	1"	18	35	83	136	300
4	1-1/4"	21	42	94	136	300
5	1-1/2"	24	54	109	136	300
6	2"	25	55	116	136	300
7	2-1/2"	31	69	144	239	256
8	3"	38	82	158	239	256
9	4"	42	99	189	295	650

ELECTRICAL CONDUIT

**NOTICE OF COMPLETION
AND
AUTHORIZATION TO APPLY THE UL MARK**



04/29/2015

Hangzhou Prostar Enterprises Ltd.
Mr. KEVIN MAO
Unit 904
Huayuan Development Building
No.639 Jianguo North Road
Hangzhou Zhejiang 310004, Cn

Our Reference:	File E365032, Vol. 1	Project Number	4786773379
Your Reference:	UL Quote#1100706650 HANGZHOU PROSTAR		
Project Scope:	USL, CNL - Swivel Band Hanger, Cat.Nos. S-050, S-075,S-100,S-125,S-150,S-200,S-250,S-300,S-350,S-400,S-500,S-600, Clevis Hanger, Cat.Nos. HDCH-050, HDCH-075, HDCH-100 ,HDCH-125, HDCH-150, HDCH-200, HDCH-250, HDCH-300, HDCH-350, HDCH-400, HDCH-500, HDCH-600, Riser Clamp, Cat.Nos. RC-050, RC-075, RC-100, RC-125, RC-150, RC-200, RC-250, RC-300,RC-350,RC-400,RC-500,RC-600		

Dear Mr. KEVIN MAO:

Congratulations! UL's investigation of your product(s) has been completed under the above Reference Number and the product was determined to comply with the applicable requirements. This letter temporarily supplements the UL Follow-Up Services Procedure and serves as authorization to apply the UL Mark at authorized factories under UL's Follow-Up Service Program. To provide your manufacturer(s) with the intended authorization to use the UL Mark, you must send a copy of this notice to each manufacturing location currently authorized under File E365032, Vol. 1.

Records in the Follow-Up Services Procedure covering the product are now being prepared and will be sent in the near future. Until then, this letter authorizes application of the UL Mark for 90 days from the date indicated above.

Additional requirements related to your responsibilities as the Applicant can be found in the document "Applicant responsibilities related to Early Authorizations" that can be found at the following web-site:
<http://www.ul.com/EAResponsibilities>

Any information and documentation provided to you involving UL Mark services are provided on behalf of UL LLC (UL) or any authorized licensee of UL.

We are excited you are now able to apply the UL Mark to your products and appreciate your business. Feel free to contact me or any of our Customer Service representatives if you have any questions.

Very truly yours,

Lisa Wang
Engineer
Lisa.Wang@ul.com

Bruce A. Mahrenholz
847-664-3009
CPO Director
Bruce.A.Mahrenholz@ul.com

Norris Wu
+86 512 6808 6400
Project Engineer
Norris.Wu@ul.com

CC: ,